

# 61 SERIES

## Multi Stack Filter Housing







The **61 Series** multi cartridge housing is available with 3, 5, 7, 10, 12, 15, 18, 19 and 22 element stacks up to 40" long. The top opening style is equipped with a Cast Vee\* clamp as standard for pressures up to 10 bar g.

These housings are widely used where low capital cost is of prime importance. Being floor mounted and therefore free standing, these housings will suit most pre-filtration applications. Bolted closures are an option available for all models.

The **61 Series** will accept either standard Double Open End or Single Open End cartridges. This includes the full range of Amazon and industry standard cartridges ranging from 0.1 to 500µm with nominal lengths of 10, 20, 30 and 40".

Accessories available include pressure gauge and vent valve kits, drain valves and bolt down plates. A new differential pressure gauge is also available to provide clear process feedback and aid in filtration optimisation.

\* Rathmann type clamp standard on 19 and 22 stack vessels

| Accessories                            |   |
|--|---|
| Pressure Gauge and Vent Valve Kit      |  |
| Pressure Gauge and Auto Vent Valve Kit |  |
| Ball Valve and Nipple                  |  |
| Differential Pressure Gauge Kit        |  |

**Note: 7, 12, 18 and 22 only accept 66.5mm maximum diameter cartridges.**



## Features and Benefits

- Differential pressure gauge accessory available to retrofit for process feedback
- Universal cup allows the use of plug in (Code 3 and Code 8) or DOE cartridge styles in the same housing
- Integral vent, clean and dirty drain sockets aid efficient filter changeout
- Vee clamp closure uses unique 'W' seal for reliable leak free operation (not available on 6119/22)
- Internally and externally electropolished to aid cleaning and hygiene
- Cast compression nut with integral PTFE seal for easy hand tight cartridge installation
- Product is DWI approved (installation into the public water supply)
- Full customised housing service available to ensure optimised installation and operation in your process

## Product Range

Amazon Filters design and manufacture an extensive range of liquid filtration systems, providing one of the widest selections of filtration vessels, depth filters and pleated cartridges available today, ensuring excellent process and filter compatibility. As one of Europe's leading manufacturers of filtration systems, Amazon Filters is able to offer a solution to meet all filtration requirements. Amazons' filters are manufactured in clean room conditions and all products come with detailed Product Validation Guides and Technical Support documentation.



**AMAZON**

# 61 Series Technical Data

## Maximum Operating Condition

|                    | 6103           | 6105/7         | 6110/12       | 6115/18        | 6119/22      |
|--------------------|----------------|----------------|---------------|----------------|--------------|
| Liquid: Vee clamp: | 10 bar g       | 10 bar g       | 10 bar g      | 7 bar g        | -            |
| Bolted closure:    | FV / 10 bar g  | FV / 10 bar g  | FV / 10 bar g | FV / 10 bar g  | FV / 6 bar g |
| Gas: Vee clamp:    | 7.5 bar g      | 4.5 bar g      | 2 bar g       | 1.5 bar g      | -            |
| Bolted closure:    | FV / 7.5 bar g | FV / 4.5 bar g | FV / 2 bar g  | FV / 1.5 bar g | FV / 1 bar g |

\* When fitted with differential pressure gauge kit, temperature limited to 80 °C.

## Materials of Construction

|                |  |
|----------------|--|
| Body:          | 316L St.Steel  |
| Closure:       | Vee Clamp - 304 St.Steel<br>Screw Clamp - Zinc plated carbon steel<br>(Optional Stainless Steel) |
| Vessel Finish: | Electropolished  |

| Connections     | 6103    | 6105/7  | 6110/12 |
|-----------------|---------|---------|---------|
| Inlet / Outlet: | 2" BSPM | 3" BSPM | 4" BSPM |
| Vent:           | ¼" BSPM | ¼" BSPM | ½" BSP  |
| Drain:          | ½" BSPM | ½" BSPM | 1" BSPM |

**PED\*/PESR\*\* Status:** Compliant with PED 2014/68/EU and PESR 2016 No. 1105  
**Fluid Groups:** Liquids Group 2  
 Gas Group 2

**Marking:** CE  
**ATEX:** Compliant with 2014/34/EU and Explosive Atmosphere Regulations 2016  
 II 2G Ex h IIC T150 Gb  
 II 2D Ex h IIC T150 Db

\* Pressure Equipment Directive

\*\* Pressure Equipment (Safety) Regulations No. 1105

Technical drawings for each individual housing showing dimensions, volume, weights, maximum temperatures and design pressures available on request.

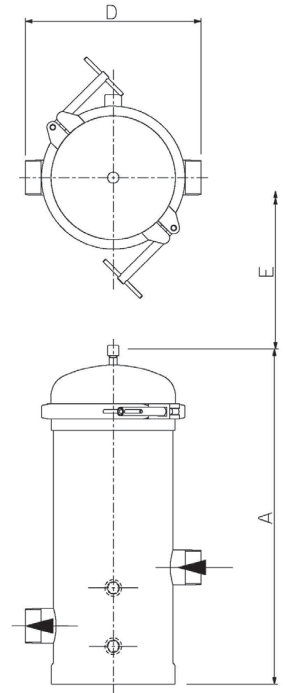

## Ordering Guide

| 6103   | 2  | 0   | A  | N                               | 20   | A   | 1                       | E                   | E   |
|--|--|---|--|---------------------------------|--|---|-------------------------|---------------------|---|
| No of Stacks   | Cartridge Length   | Cartridge End Cap Style                                 | Closure Style  | Mounting                        | Connection   | Connection Type   | Materials               | Finish              | Seal  |
| 6103 - 3<br>6105 - 5<br>6107 - 7<br>6110 - 10<br>6112 - 12<br>6115 - 15<br>6118 - 18<br>6119 - 19<br>6122 - 22 | 1 - 10"<br>(6103 & 6105 only)<br>2 - 20"<br>3 - 30"<br>4 - 40" | 0 - Code 0<br>A - Code A<br>U - Universal<br>8 - Code 8 | A - Cast Vee Clamp<br>(Not available on 6119/22)<br>E - Lid with Screw Clamps<br>(6110 & 6115 only)<br>H - Hinged Cover with Carbon Steel Screw Clamps<br>(6103, 6105, 6119 & 6122 only)<br>J - Flat Lid with Screw Clamps & Davit<br>(6119/22 only)<br>W - Hinged Cover with St.St screw Clamps<br>(6103 & 6105 only) | N - None<br>A - Bolt Down Plate | 3-7 Stack<br>20 - 2"<br>30 - 3" (6105 Only)<br>10 - 22 Stack<br>30 - 3"<br>40 - 4" | A - BSPM<br>C - EN1092-1 Flange PN16<br>G - Table 'E' Flange<br>H - ASME Flange 150#<br>K - Stub Pipe<br>L - BS4825-3 Tri Clamp<br>M - DIN11851 Coupling<br>N - RJTM<br>P - SMS M (Swedish)<br>R - IDFM<br>S - DIN2633 Flange<br>U - NPTM (2" only) | 1 - 316 st.st (L Grade) | E - Electropolished | E - EPDM<br>F - FEP / Silicone (Bolted cover only)<br>S - Silicone (not available on 6115)<br>V - Viton |

Example: 610320AN20A1EE = 61 Series, 3 x 20" DOE cartridge, Cast vee clamp closure, No mounting, 2" BSPM connections. 316L St.Steel construction with EPDM gaskets, electropolished all over.  
 Note: Not all options are available on every housing, please refer to Sales Office.

# AMAZON FILTERS LTD.

Albany Park Estate, Camberley, Surrey, GU16 7PG, ENGLAND

Tel: +44 (0) 1276 670 600 Email: sales@amazonfilters.co.uk Web: www.amazonfilters.com

SupaPore is a trademark of Amazon Filters Ltd.

AMAZON FILTERS LTD. reserve the right to change specification without prior notice, as part of their continuous product development programme.